

Pin assignment at multi-pin connectors on instrument cluster - vehicles up to model year 1997

Multi-pin connector, 26-pin, blue

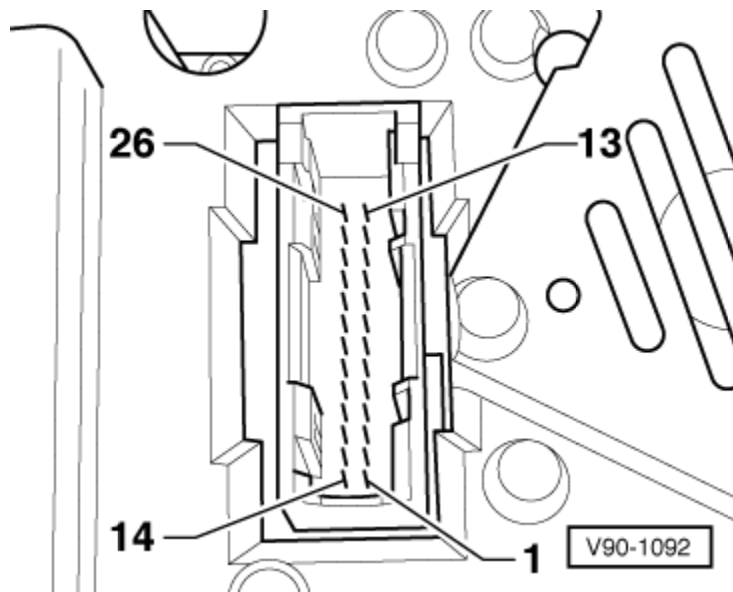

1. Not used
2. Buzzer activation
3. Terminal 15
4. Terminal 15
5. Not used
6. Terminal 61
7. Handbrake/brake fault
8. ABS (direct)
9. Airbag (direct)
10. CAT
11. ABS (inverted)
12. Airbag (inverted)
13. Right parking light
14. Ignition lock S contact
15. Not used
16. Not used
17. Gong activation
18. Oil pressure 1.8 bar

- 19. Terminal 58d
- 20. Coolant level
- 21. Turn signal (right-side)
- 22. Main beams
- 23. Speedometer input
- 24. Brake fluid
- 25. Brake pad
- 26. Left parking light

Multi-pin connector, 26-pin, yellow

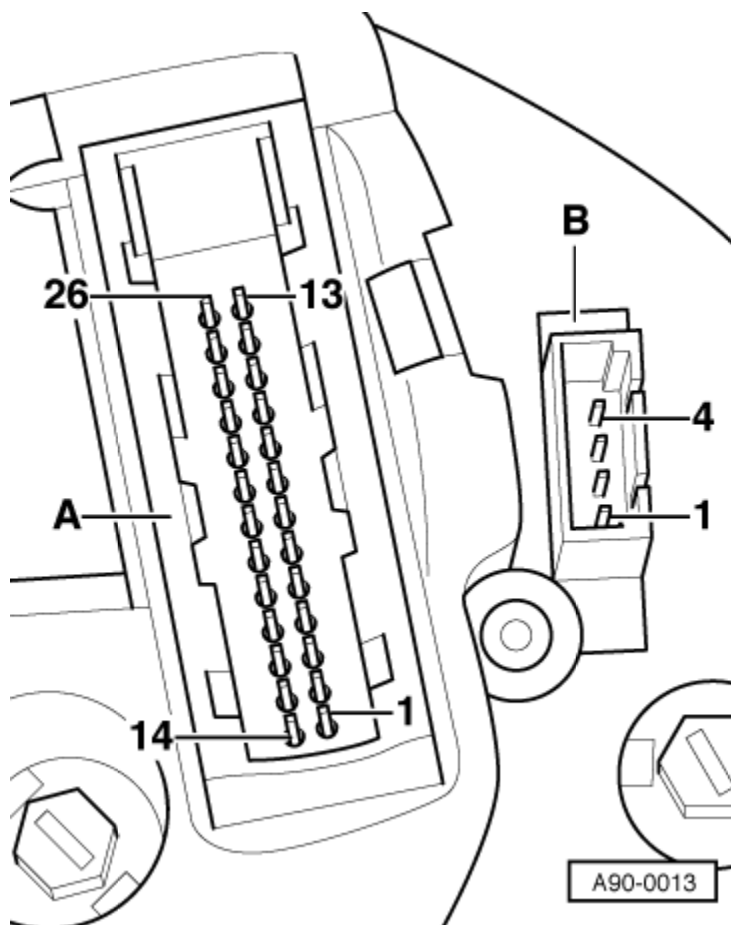

- 1. Terminal 58
- 2. Terminal 58
- 3. Engine speed signal
- 4. Air conditioner compressor
- 5. Clock - output
- 6. Road speed signal 1
- 7. Road speed signal 2

8. Door contact, driver's side
 9. Terminal 30
 10. Terminal 30
 11. Not used
 12. Fuel tank warning
 13. Turn signal (left-side)
 14. Not used
 15. Not used
 16. Belt buckle switch
 17. Not used
 18. Terminal 31
 19. Terminal 31
 20. Diagnosis lead
 21. Not used
 22. Not used
 23. Glow period warning lamp
 24. Immobiliser
 25. Fuel gauge sender
 26. Coolant temperature sender
-

Multi-pin connector, 20-pin, black

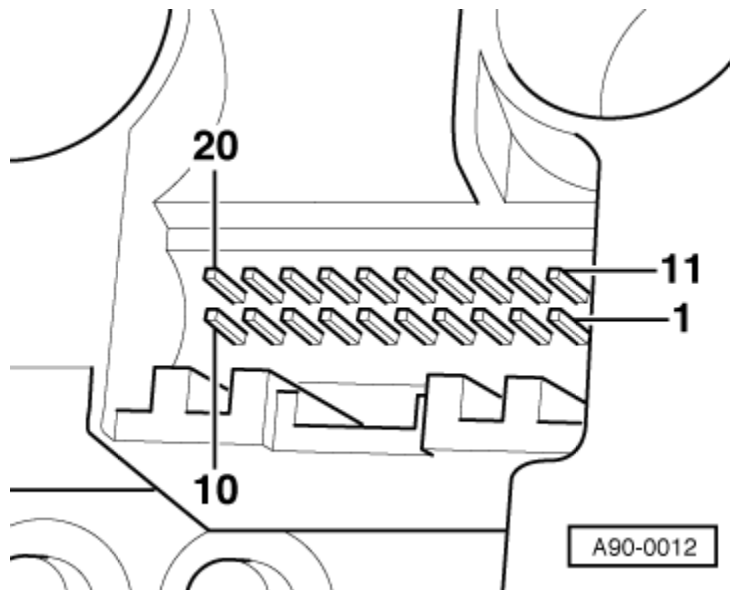

1. Fuel consumption signal
2. Not used
3. Not used
4. Not used
5. Ambient temperature

6. Gear selection indicator
7. Not used
8. Not used
9. Coolant level
10. Hydraulic pressure
11. On-board computer: reset
12. Radio/telephone - clock
13. Radio/telephone - data
14. On-board computer, left
15. Radio/telephone - enable
16. Tail lights / dipped beams
17. Glow plug relay
18. On-board computer, right
19. Brake light
20. Not used

Multi-pin connector, 4-pin, black

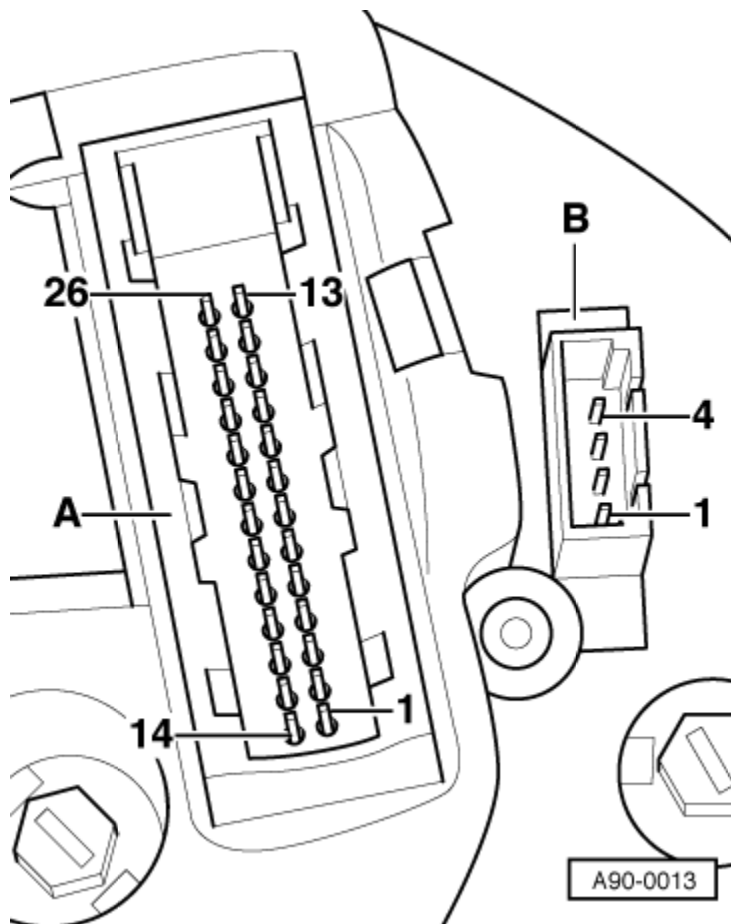

1. Oil temperature sender
2. Not used
3. Not used
4. Not used